

EXPLODED
VIEW
CELDEK
11/18/2016

CELDEK 1/2/3 EXPLODED VIEW

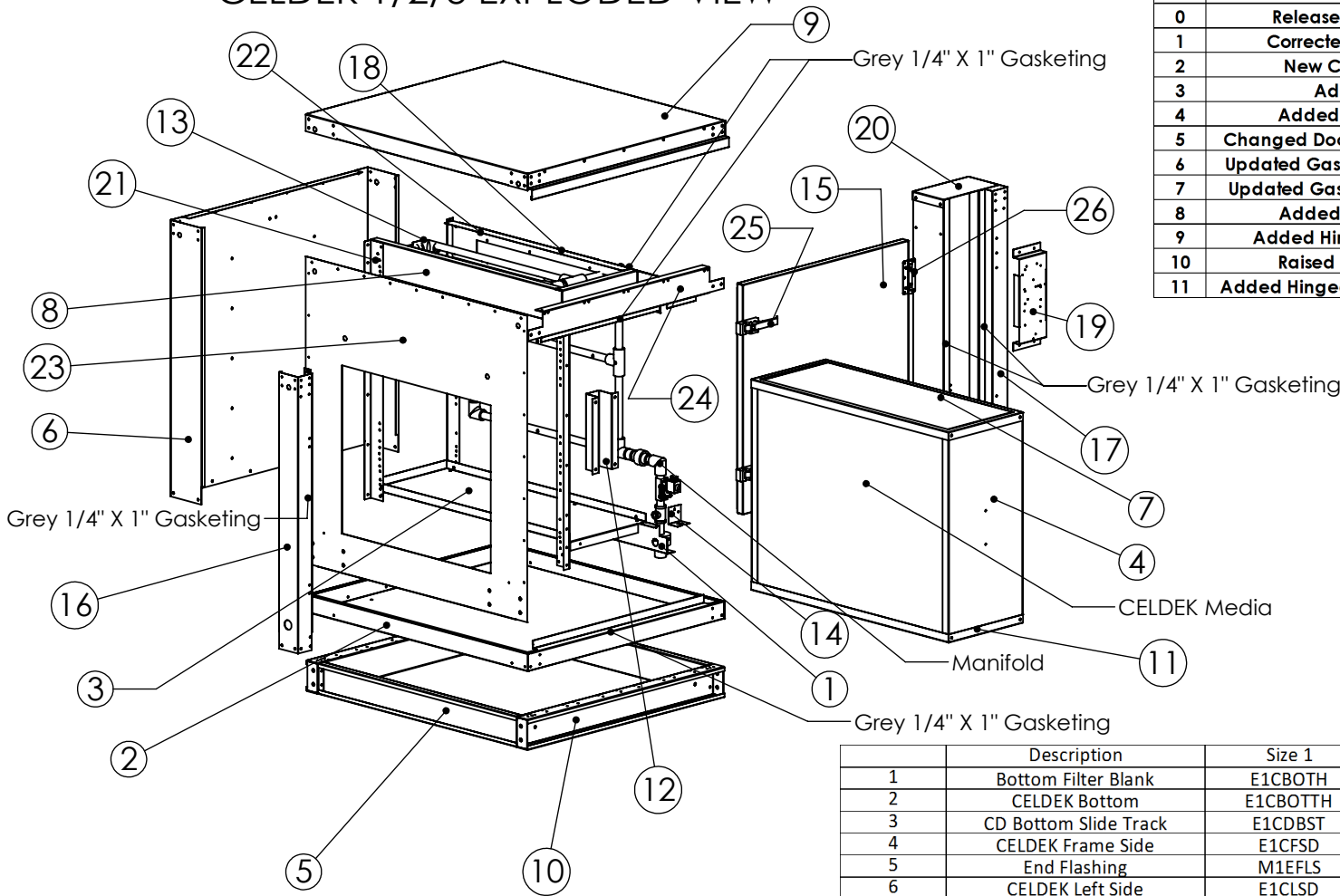

Revision History				
#	Description	Revised by	ECN#	Date
0	Released to production	JTS	----	----
1	Corrected Part Numbers	JTS		10/3/06
2	New Celdek Design	BCW	1255	2/4/08
3	Added Size 6	AJK	1819	11/20/09
4	Added Top Door Seal	NR	2207	1/17/11
5	Changed Door Hook Part Number	NR	2393	1/25/12
6	Updated Gasket on Top Door Seal	NR	2524	8/24/12
7	Updated Gasket on Top Manifold	NR	2562	10/30/12
8	Added Door Handles	JJH	2594	2/27/13
9	Added Hinged Doors to 4/5	JJH	2789	6/17/15
10	Raised Celdek Media	PEM	2844	10/20/15
11	Added Hinged Doors to sizes 1/2/3	DAM	2795	11/18/16

Celdek Media Size		
For	Dimensions	Part Number
Size 1	24x20x12	CD-1 MEDIA
Size 2	32x25x12	CD-2 MEDIA
Size 3	36x30x12	CD-3 MEDIA

	Description	Size 1	#	Size 2	#	Size 3	#
1	Bottom Filter Blank	E1CBOTH	1	E2CBOTH	1	E3CBOTH	1
2	CELDEK Bottom	E1CBOTTH	1	E2CBOTTH	1	E3CBOTTH	1
3	CD Bottom Slide Track	E1CDBST	1	E2CDBST	1	E3CDBST	1
4	CELDEK Frame Side	E1CFSD	2	E2CFSD	2	E3CFSD	2
5	End Flashing	M1EFLS	2	M2EFLS	2	M3EFLS	2
6	CELDEK Left Side	E1CLSD	1	E2CLSD	1	E3CLSD	1
7	CELDEK Frame Top	E1CFTP	1	E2CFTP	1	E3CFTP	1
8	CELDEK Top Shield	E1CDTS	1	E2CDTSH	1	E3CDTSH	1
9	Lid	E1LIDD	1	E2LIDD	1	E3LIDD	1
10	Main Rail	ME12MR	2	ME12MR	2	ME3MNRL	2
11	CELDEK Frame Bottom	E1CFBM	1	E2CFBM	1	E3CFBM	1
12	Celdek Stop	N/A	N/A	EC25STPH	1	EC25STPH	1
13	CELDEK Spraybar Bracket	MEC15SB	1	MEC15SB	1	MEC15SB	1
14	Sensor Mount	ME15SM	1	ME15SM	1	ME15SM	1
15	Right Door	EC1RDORH	1	EC2RDORH	1	EC3RDORH	1
Not Shown	Right Door Liner	E1RDORHL	1	E2RDORHL	1	E3RDORHL	1
16	Right Rear Door Jam	E1RRDJH	1	E2RRDJH	1	E3RRDJH	1
17	Right Front Post	E1CRTFPH	1	E2CRTFPH	1	E3CRTFPH	1
18	CELDEK Top Manifold	E1CDTPMAN	1	E2CDTPMANH	1	E3CDTPMANH	1
19	Electric Board	MEEBRD	1	MEEBRD	1	MEEBRD	1
20	Electric Cabinet Cap	MEECAP	1	MEECAP	1	MEECAP	1
21	Filter Track Support	E1FTSPH	2	E2FTSPH	3	E3FTSPH	3
Not Shown	EC Celdek Media Support	E1CDTMSH*	1	N/A	N/A	N/A	N/A
22	CELDEK Manifold Cover	E1CDMANCV	1	E2CDMANCVH	1	E3CDMANCVH	1
23	Adapter Plate	N/A	N/A	21ADP	1	32ADP	1
24	Top Door Seal	E1CTDSPH	1	E2CTDSPH	1	E3CTDSPH	1
Not Shown	Bottom Removable Flange	E1BRMFH**	1	N/A	N/A	N/A	N/A
25	Latch	A7-10-351-20	1	A7-10-351-20	2	A7-10-351-20	2
26	Hinges	HG-OTA100	2	HG-OTA100	2	HG-OTA100	2

NOTES:

- 1) Drain Kit Part Numbers: Strainer - EC120, P-Trap - EC125
- 2) Apply Grey 1/4" x 1" Gasketing when Adapter Plate is used.
- 3) Add 1 hole conduit clips (part# MIC0202, AX# A0022514) to the E#SPWL to support the water line.
- 4) Add Grey 1/4" x 1" Gasket to perimeter of Celdek Stop (EC**STPH) facing Celdek Media.

* Celdek Media Support(E1CDTMSH) is used in place of filter track closest to door on size 1 units. Apply Grey 1/4" x 1" Gasket to flange facing door.

** For size 1 units apply Gray 1/4" x 1" Gasket to E1BRMFH and place it on the flange facing the door opening of the Celdek Bottom.

CELDEK 4/5/6 EXPLODED VIEW

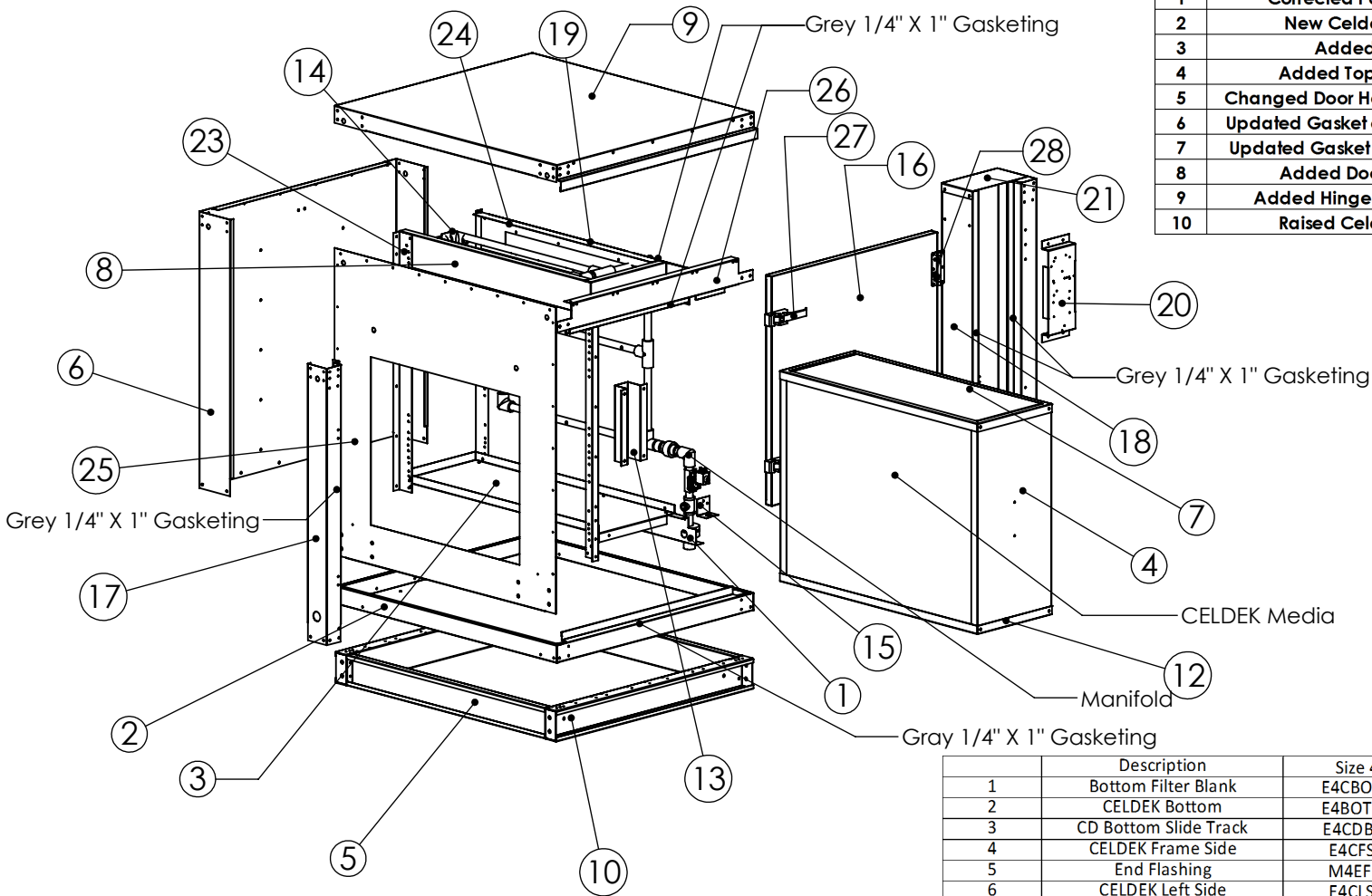

#	Description	Revised by	ECN#	Date
0	Released to production	JTS	----	----
1	Corrected Part Numbers	JTS		10/3/06
2	New Celdek Design	BCW	1255	2/4/08
3	Added Size 6	AJK	1819	11/20/09
4	Added Top Door Seal	NR	2207	1/17/11
5	Changed Door Hook Part Number	NR	2393	1/25/12
6	Updated Gasket on Top Door Seal	NR	2524	8/24/12
7	Updated Gasket on Top Manifold	NR	2562	10/30/12
8	Added Door Handles	JJH	2594	2/27/13
9	Added Hinged Doors to 4/5	JJH	2789	6/17/15
10	Raised Celdek Media	PEM	2844	10/20/15

Celdek Media Size		
For	Dimensions	Part Number
Size 4	48x38x12	CD-4 MEDIA
Size 5	54x45x12	CD-5 MEDIA
Size 6	72x45x12	CD-6 MEDIA**

** Includes (2) 36x45x12 media cartridges.

NOTES:

- Size 6 CELDEK Frame Side uses E5CFSD for Handle Side and E6CFSD for the other. 2parts of each.
- Drain Kit Part Numbers: Strainer - EC120, P-Trap - EC125
- Apply Grey 1/4" x 1" Gasketing when Adapter Plate is used.
- Add 1 hole conduit clips (part# MIC0202, AX# A0022514) to the E#SPWL to support the water line.
- Add Grey 1/4" x 1" Gasket to perimeter of Celdek Stop (EC**STPH) facing Celdek Media.

	Description	Size 4	#	Size 5	#	Size 6	#
1	Bottom Filter Blank	E4CBOTH	1	E5CBOTH	1	E6BFBLH	1
2	CELDEK Bottom	E4BOTTH	1	E5BOTTH	1	E6CBOTH	1
3	CD Bottom Slide Track	E4CDBST	1	E5CDBST	1	E6CDBST	1
4	CELDEK Frame Side	E4CFSD	2	E5CFSD	2	E6CFSD*	2
5	End Flashing	M4EFLS	2	M5EFLS	2	M6EFLS	2
6	CELDEK Left Side	E4CLSD	1	E5CLSD	1	E5CLSD	1
7	CELDEK Frame Top	E4CFTP	1	E5CFTP	1	E3CFTP	2
8	CELDEK Top Shield	E4CDTS	1	E5CDTS	1	E6CDTS	1
9	Lid	E4LIDD	1	E5LIDD	1	E6LIDD	1
10	Main Rail	ME45MR	2	ME45MR	2	ME45MR	2
12	CELDEK Frame Bottom	E4CFBM	1	E5CFBM	1	E3CFBM	2
13	Celdek Stop	EC25STPH	1	EC25STPH	1	N/A	0
14	CELDEK Spraybar Bracket	MEC15SB	1	MEC15SB	1	MEC15SB	1
15	Sensor Mount	ME15SM	1	ME15SM	1	ME15SM	1
16	Right Door	E4RDORH	1	E5DORH	1	E5DORH	1
17	Right Rear Door Jam	E4CRRDJH	1	E5CRRDJH	1	E5CRRDJH	1
Not Shown	Right Rear Door Liner	E4DORHL	1	E5RDORHL	1	E5RDORHL	1
18	Right Front Post	E4CRTFPH	1	E5CRTFPH	1	E5CRTFPH	1
19	CELDEK Top Manifold	E4CDTPMAN	1	E5CDTPMAN	1	E6CDTPMAN	1
20	Electric Board	MEEBRD	1	MEEBRD	1	MEEBRD	1
21	Electric Cabinet Cap	MEECAP	1	MEECAP	1	MEECAP	1
Not Shown	Water Line Support	E4SPWL	1	E5SPWL	1	E5SPWL	2
23	Filter Track Support	E4FTSP	3	E5FTSP	3	E5FTSP	3
24	CELDEK Manifold Cover	E4CDMANCV	1	E5CDMANCV	1	E6CDMANCV	1
25	Adapter Plate	43ADP	1	54ADP	1	65ADP	1
Not Shown	Top Tubing Support	N/A	N/A	N/A	N/A	E6TBSB	1
26	Top Door Seal	E4CTDSH	1	E5CTDSH	1	E5CTDSH	1
27	Latch	A7-10-351-20	2	A7-10-351-20	2	A7-10-351-20	2
28	Hinges	HG-OTA100	3	HG-OTA100	3	HG-OTA100	3